

SIZE	STANDARD HEXNUT		HEAVY HEXNUT	
	A	B	A	B
1/4"-20UNC	7/16"	7/32"	1/2"	15/64"
5/16"-18UNC	1/2"	17/64"	9/16"	19/64"
3/8"-16UNC	9/16"	21/64"	11/16"	23/64"
7/16"-14UNC	11/16"	3/8"	3/4"	27/64"
1/2"-13UNC	3/4"	7/16"	7/8"	31/64"
5/8"-11UNC	7/8"	31/36"	15/16"	35/64"
3/4"-10UNC	15/16"	35/64"	1-1/16"	39/64"
7/8"-9UNC	1-1/8"	41/64"	1-1/4"	47/64"
1"-8UNC	1-5/16"	3/4"	1-7/16"	55/64"

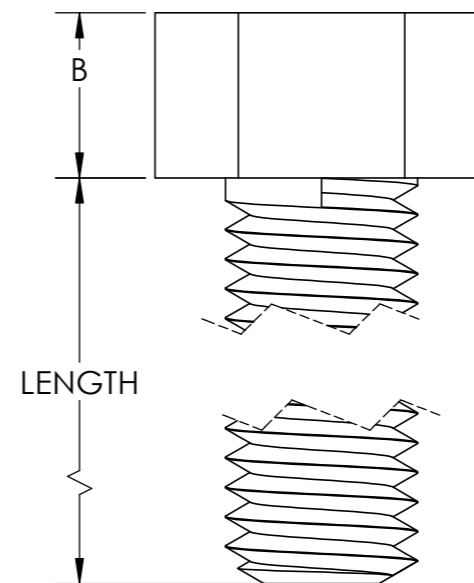
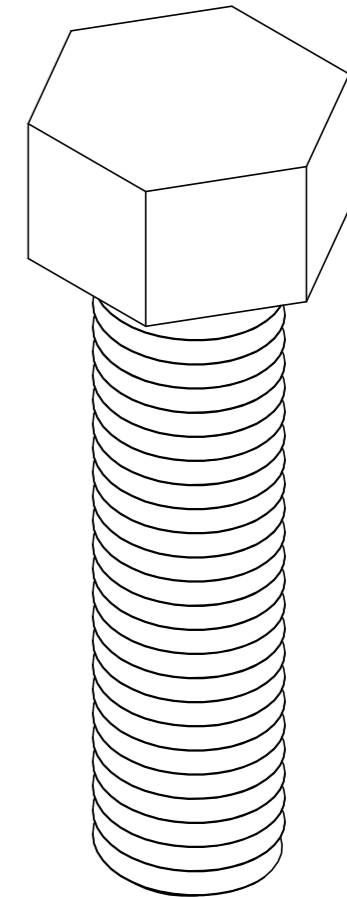
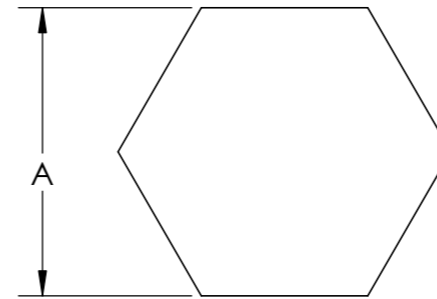

0	12 JAN 16	INITIAL RELEASE	PJV	---
REV	DATE	DESCRIPTION	DWN	APPR

TOLERANCES UNLESS OTHERWISE SPECIFIED		REF.	MARKING DATA		1911 JASMINE PASADENA TX, 77503 <small>THIS DRAWING, AND ALL INFORMATION CONTAINED IN IT, IS CONFIDENTIAL, PROPRIETARY, AND IS THE SOLE PROPERTY OF Vee Interests LLC AND MAY NOT BE REPRODUCED, COPIED OR DISTRIBUTED WITHOUT THE EXPRESS WRITTEN CONSENT OF Vee.</small>
DIMENSIONS ARE IN INCHES		1	KK		
.X ± .1	CONC.... .010 TIR	DWN. BY: PJV			
.XX ± .03	FINISH.... 125 RMS	CHK. BY:			
.XXX ± .010	RADII.... .015 MAX	APPR. BY:			
ANGLES... ± 0°30' BREAK SHARP EDGES .015 MAX.		DO NOT SCALE		SCALE 1:1	SHEET 1 OF 1
EST. WEIGHT: 0.14 LB		SIZE B	DRAWING NO. VEE-1181	REV. 0	

HEX BOLT & HEAVY HEX BOLT DIMENSIONS